

# MID-CONTINENT ENERGY EXCHANGE

## Oil & Gas Asset Auctions



Data Packet

## **Speirs 'A' 2-30**

**Overriding Royalty Interest in  
Edwards County, KS**

***In this Document:***

[Lot Summary](#)

[Income and Expenses](#)

[Production](#)

[Misc.](#)

[Outgoing Conveyance](#)



# Summary

## Lot Summary

**Lease Name:** Speirs 'A' 2-30 ORRI

**County/State:** Edwards, KS

**Asset Type:** Overriding Royalty Interest

**Legal Description:** L1, L2, S/2 NE/4 Sec 30-26S-20W

**API:** 15-047-21444

**Decimal Interest:** 0.00208333

**Net Monthly Income:** \$69.88

**Operator:** McCoy Petroleum Corp.

**Purchaser:** CHS McPherson Refinery, Inc.

Well Name	API	Lease #	Type	Zone	Status
Speirs 'A' 2-30	15-047-21444	135133	Oil	Mississippian	Producing

Disclaimer: Bidders must conduct their own due diligence prior to bidding at the auction. Bidders shall rely upon their own evaluations of the properties and not upon any representation either oral or written provided here. This is a summary of information provided by the seller to Mid-Continent Energy Exchange.



# *Income and Expenses*

## *Summary*

9 months income info

Net Income: \$628.94

Per Month: \$69.88

Net income represents 1/3 of seller's interest

LEASE	ORRI	Sept 2023	Oct 2023	Nov 2023	Dec 2023	Jan 2024	Feb 2024	Mar 2024	Apr 2024	May 2024	Average
SPEIRS 'A' 2-30	0.00208333	\$95.44	\$80.99	\$71.33	\$44.88	\$63.16	\$69.82	\$75.54	\$78.39	\$49.39	<b>\$69.88</b>

**CHS McPherson Refinery Inc.**  
**ATTENTION CRUDE OIL ACCOUNTING**

**2000 S MAIN**

**McPHERSON, KANSAS 67460**  
REFER TO LEASE NO. AND OWNER NO. WHEN  
WRITING OR CALLING. FOR QUESTIONS OR  
INFORMATION PLEASE CALL 1-620-241-9183

**DATED 09/18/2023**  
**Owner #**

LEASE #		LEASE NAME				LOCATION				OPERATOR			
PROD MO/YR	BBL/ MCF	PRICE	GROSS VALUE	LEASE TAXES	NET VALUE	DECIMAL OF INTEREST	INT TYPE	OWNER GROSS VALUE	TAX TYPE	OWNER TAX	OWNER NET VALUE		
104503	Speirs A #2-30			Edwards COUNTY, KS				McCoy Petroleum Corporation					
08-23	327.94	77.69	25478.83	47.22	24328.38	.0062500	ORRI	159.24	KCC	0.30	152.04		
				1103.23					SEV	6.90			

YTD Owner Grs Val:  
YTD Owner Tax:  
YTD Owner Net Val:

**CHS McPherson Refinery Inc.**  
**ATTENTION CRUDE OIL ACCOUNTING**

**2000 S MAIN**

**McPHERSON, KANSAS 67460**  
REFER TO LEASE NO. AND OWNER NO. WHEN  
WRITING OR CALLING. FOR QUESTIONS OR  
INFORMATION PLEASE CALL 1-620-241-9183

**Advice #**  
**DATED 10/18/2023**  
**Owner #**

LEASE #		LEASE NAME				LOCATION				OPERATOR			
PROD MO/YR	BBL/ MCF	PRICE	GROSS VALUE	LEASE TAXES	NET VALUE	DECIMAL OF INTEREST	INT TYPE	OWNER GROSS VALUE	TAX TYPE	OWNER TAX	OWNER NET VALUE		
104503	Speirs A #2-30			Edwards COUNTY, KS				McCoy Petroleum Corporation					
09-23	562.09	85.34	47968.20	80.94	45810.24	.0062500	ORRI	299.80	KCC	0.51	286.31		
				2077.02					SEV	12.98			

YTD Owner Grs Val:  
YTD Owner Tax:  
YTD Owner Net Val:

**CHS McPherson Refinery Inc.**  
**ATTENTION CRUDE OIL ACCOUNTING**

**2000 S MAIN**

**McPHERSON, KANSAS 67460**  
REFER TO LEASE NO. AND OWNER NO. WHEN  
WRITING OR CALLING. FOR QUESTIONS OR  
INFORMATION PLEASE CALL 1-620-241-9183

Advice #  
DATED 11/17/2023  
Owner #

LEASE #		LEASE NAME				LOCATION				OPERATOR			
PROD MO/YR	BBL/ MCF	PRICE	GROSS VALUE	LEASE TAXES	NET VALUE	DECIMAL OF INTEREST	INT TYPE	OWNER GROSS VALUE	TAX TYPE	OWNER TAX	OWNER NET VALUE		

YTD Owner Grs Val:  
YTD Owner Tax:  
YTD Owner Net Val:

**CHS McPherson Refinery Inc.**  
**ATTENTION CRUDE OIL ACCOUNTING**

**2000 S MAIN**

**McPHERSON, KANSAS 67460**  
REFER TO LEASE NO. AND OWNER NO. WHEN  
WRITING OR CALLING. FOR QUESTIONS OR  
INFORMATION PLEASE CALL 1-620-241-9183

**Advice # 1**  
**DATED 12/18/2023**  
**Owner #**

LEASE #		LEASE NAME				LOCATION				OPERATOR			
PROD MO/YR	BBL/ MCF	PRICE	GROSS VALUE	LEASE TAXES	NET VALUE	DECIMAL OF INTEREST	INT TYPE	OWNER GROSS VALUE	TAX TYPE	OWNER TAX	OWNER NET VALUE		
104503	Speirs A #2-30			Edwards COUNTY, KS				McCoy Petroleum Corporation					
11-23	487.33	73.59	35863.11	70.18	34240.06	.0062500	ORRI	224.14	KCC	0.44	213.99		
				1552.87					SEV	9.71			

YTD Owner Grs Val:  
YTD Owner Tax:  
YTD Owner Net Val:





**CHS McPherson Refinery Inc.**  
**ATTENTION CRUDE OIL ACCOUNTING**

**2000 S MAIN**

**McPHERSON, KANSAS 67460**  
REFER TO LEASE NO. AND OWNER NO. WHEN  
WRITING OR CALLING. FOR QUESTIONS OR  
INFORMATION PLEASE CALL 1-620-241-9183

Advice #  
DATED 02/20/2024  
Owner #

LEASE #		LEASE NAME			LOCATION			OPERATOR			
PROD MO/YR	BBL/ MCF	PRICE	GROSS VALUE	LEASE TAXES	NET VALUE	DECIMAL OF INTEREST	INT TYPE	OWNER GROSS VALUE	TAX TYPE	OWNER TAX	OWNER NET VALUE
104503	Speirs A #2-30			Edwards COUNTY, KS			McCoy Petroleum Corporation				
01-24	452.62	70.16	31756.11	65.18	30315.89	.0062500	ORRI	198.48	KCC	0.41	189.47
				1375.04					SEV	8.60	

YTD Owner Grs  
YTD Owner Ta  
YTD Owner Net

**CHS McPherson Refinery Inc.**  
**ATTENTION CRUDE OIL ACCOUNTING**

**2000 S MAIN**

**McPHERSON, KANSAS 67460**  
REFER TO LEASE NO. AND OWNER NO. WHEN  
WRITING OR CALLING. FOR QUESTIONS OR  
INFORMATION PLEASE CALL 1-620-241-9183

**Advice #**  
**DATED 03/18/2024**  
**Owner #**

LEASE #		LEASE NAME			LOCATION				OPERATOR			
PROD MO/YR	BBL/ MCF	PRICE	GROSS VALUE	LEASE TAXES	NET VALUE	DECIMAL OF INTEREST	INT TYPE	OWNER GROSS VALUE	TAX TYPE	OWNER TAX	OWNER NET VALUE	
104503	Speirs A #2-30			Edwards COUNTY, KS				McCoy Petroleum Corporation				
02-24	481.94	72.84	35102.52	69.40	33513.18	.0062500	ORRI	219.39	KCC	0.44	209.45	
				1519.94					SEV	9.50		

YTD Owner Grs Val:  
YTD Owner Tax:  
YTD Owner Net Val:

**CHS McPherson Refinery Inc.**  
**ATTENTION CRUDE OIL ACCOUNTING**

**2000 S MAIN**

**McPHERSON, KANSAS 67460**  
REFER TO LEASE NO. AND OWNER NO. WHEN  
WRITING OR CALLING. FOR QUESTIONS OR  
INFORMATION PLEASE CALL 1-620-241-9183

Advice #  
DATED 04/18/2024  
Owner #

LEASE #		LEASE NAME				LOCATION			OPERATOR			
PROD MO/YR	BBL/ MCF	PRICE	GROSS VALUE	LEASE TAXES	NET VALUE	DECIMAL OF INTEREST	INT TYPE	OWNER GROSS VALUE	TAX TYPE	OWNER TAX	OWNER NET VALUE	
104503	Speirs A #2-30				Edwards COUNTY, KS			McCoy Petroleum Corporation				
03-24	494.53	76.80	37977.66	71.21	36262.02	.0062500	ORRI	237.36	KCC	0.45	226.63	

YTD Owner Grs Val:  
YTD Owner Tax:  
YTD Owner Net Val:



**CHS McPherson Refinery Inc.**  
**ATTENTION CRUDE OIL ACCOUNTING**

**2000 S MAIN**

**McPHERSON, KANSAS 67460**  
REFER TO LEASE NO. AND OWNER NO. WHEN  
WRITING OR CALLING. FOR QUESTIONS OR  
INFORMATION PLEASE CALL 1-620-241-9183

**Advice #**  
**DATED 05/17/2024**  
**Owner #**

LEASE #		LEASE NAME			LOCATION			OPERATOR			
PROD MO/YR	BBL/ MCF	PRICE	GROSS VALUE	LEASE TAXES	NET VALUE	DECIMAL OF INTEREST	INT TYPE	OWNER GROSS VALUE	TAX TYPE	OWNER TAX	OWNER NET VALUE
</											

YTD Owner Grs Val:  
YTD Owner Tax:  
YTD Owner Net Val:



***Production***



SPEIRS 'A' 2-30 135133

Lease #: 135133

Lease and Production Information

State	County	Operator			
KS	EDWARDS	MCCOY PETROLEUM CORPORATION			
Location	Meridan	Quarter Call	Formation	Horizontal	Production Months
30-26S-20W	6th (west -96.28)		Oil	No	282
					Gas
First Prod Date			2000-09-01		
Last Sale			2024-02-01		
Daily Rate			15.18		
MoM Change			36		
YoY Change			491		
Cumulative			213549		

Production Snapshot

Month	BOPM	MCFPM
03-2023	645	
04-2023	492	
05-2023	495	
06-2023	492	
07-2023	494	
08-2023	328	
09-2023	562	
10-2023	496	
11-2023	487	
12-2023	329	
01-2024	453	
02-2024	488	
Average	480	

Annual Averages

Year	Avg BOPM	Avg MCFPM
2020	518	
2021	522	
2022	439	
2023	471	
2024	470	

# SPEIRS 'A' 2-30 135133 - Production Plot

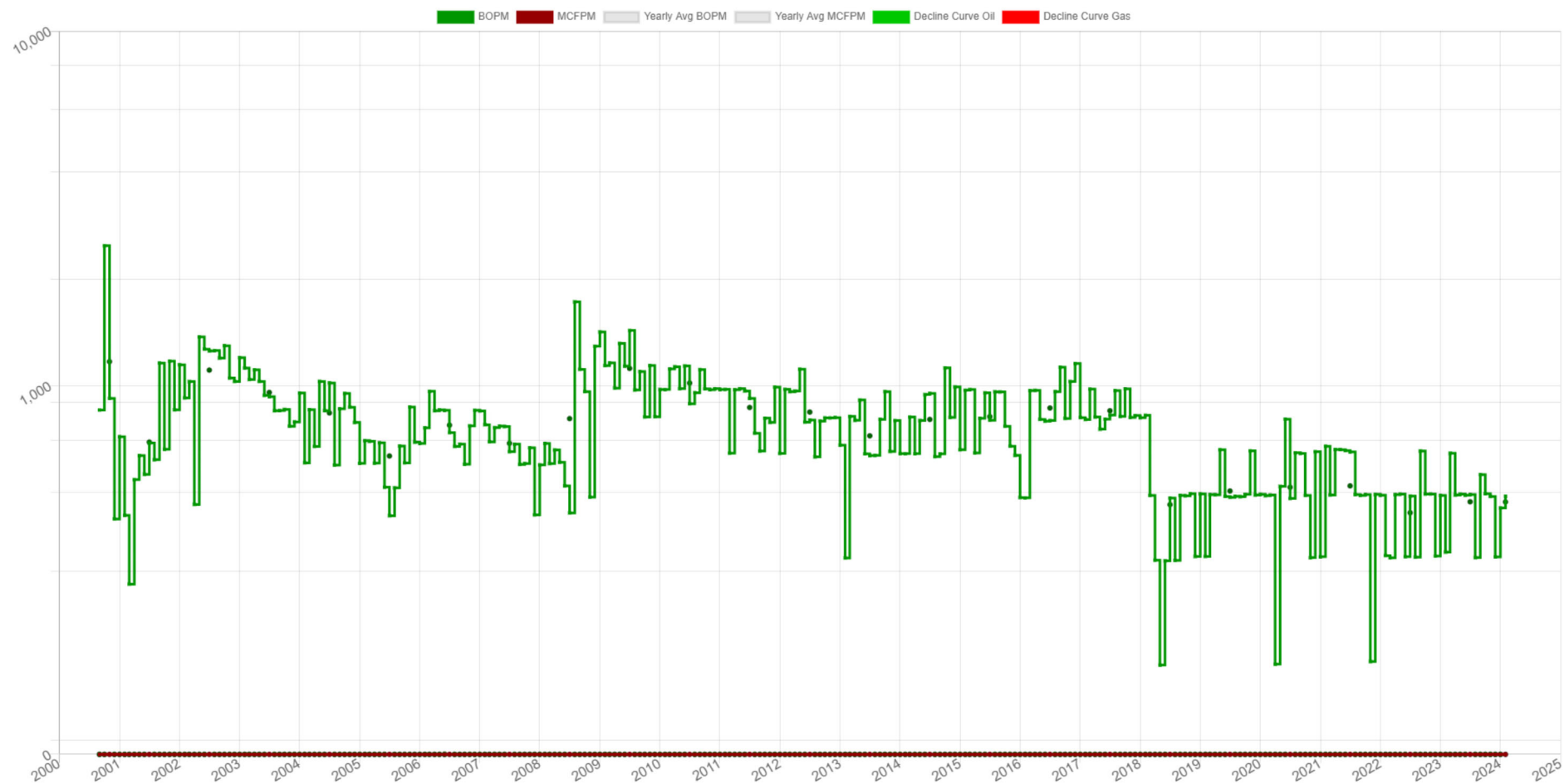





SPEIRS 'A' 2-30 135133

Associated Wells

Total Well Count: 2

Well Name	API		Operator			Type	Status
SPEIRS 'A' 1-30	15047214410000		MCCOY PETROLEUM CORPORATION			O&G-P&A	P&A
Location	Spot	Foot-NS	Foot-EW	Foot-ref	Zone		
30-26S-20W	SE NE	-1980	-660	NE	MISSISSIPPIAN		
Spud	Completion		First Production				
2000-03-01	2000-03-30						
Elevation	MD	TV-TD	Cmpl-Top	Cmpl-Btm	PBTD	Drill-Dir	Lateral
2263 KB		4795					

Well Name	API		Operator			Type	Status
SPEIRS 'A' 2-30	15047214440000		MCCOY PETROLEUM CORPORATION			O&G	Producing
Location	Spot		Foot-NS	Foot-EW	Foot-ref	Zone	
30-26S-20W	W2 NE NE		4620	-990	SE	MISSISSIPPIAN	
Spud			Completion	First Production			
2000-08-05			2000-09-05				
Elevation	MD	TV-TD	Cmpl-Top	Cmpl-Btm	PBTD	Drill-Dir	Lateral
2261 KB		4781					



# *Misc. Info*



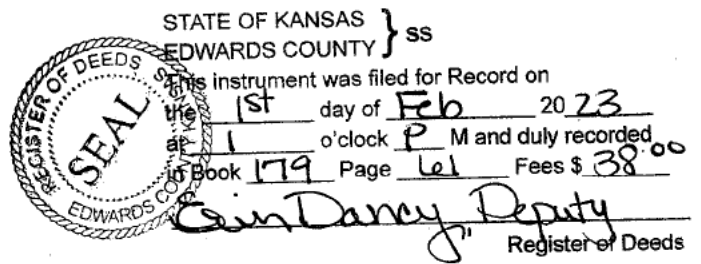

ASSIGNMENT OF OVERRIDING ROYALTY

KNOW ALL MEN BY THESE PRESENTS:

That the undersigned, **COREY BAKER**, hereinafter called Assignor, for and in consideration of Ten Dollars (\$10.00) and other good and valuable consideration, the receipt and sufficiency of which is hereby acknowledged, does hereby sell, assign, transfer and set over unto the following parties in the amounts shown below in and to the Overriding Royalty Interest in the following oil and gas leases hereinafter set forth in Exhibit "A" attached hereto and made a part hereof.

ASSIGNEE

INTEREST CONVEYED

[REDACTED]

.00625000 ORRI

**RONALD J. MERSMAN & CHERYL K. MERSMAN  
TRUST DTD 3-10-2006**

.01250000 ORRI

[REDACTED]

**LYNDON D. BOYER & GERALDINE L. BOYER  
REVOCABLE LIVING TRUST U/A DTD 9-27-2002**

.00625000 ORRI

[REDACTED]

All the provisions of this Assignment shall be available to and binding upon the respective heirs, executors, administrators, successors and assigns of the Assignor and Assignee herein.

EXECUTED this 20<sup>th</sup> day of January, 2023; however EFFECTIVE as of January 1, 2023.

By: [REDACTED]  
Corey Baker

ACKNOWLEDGEMENT

STATE OF KANSAS )  
 ) ss.  
COUNTY OF SEDGWICK )

BE IT REMEMBERED, that on this 20<sup>th</sup> day of January, 2023, before me, the undersigned, a notary public in and for the county and state aforesaid, came Corey Baker, and who is personally known to me to be one in the same person who executed the within instrument of writing and such person duly acknowledged the execution of the same.

IN TESTIMONY WHEREOF, I have hereunto set my hand and affixed my official seal the day and year last above written.

X: [REDACTED]  
COURTNEY L. JENSEN Notary Public  
My appointment expires:  
12.27.24

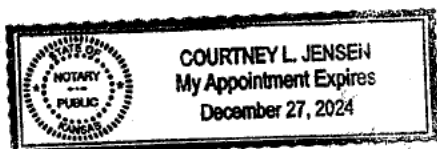

## EXHIBIT "A"

Attached to and made part of that certain Assignment of Overriding Royalty dated January 20, 2023 covering the following described lands located in EDWARDS COUNTY, KANSAS, to-wit:

**Oil and Gas Leases: Wetzel D:**

Instrument: Oil and Gas Lease  
Date: March 10, 2000  
Lessor: Dora Wetzel, a widow  
Lessee: McCoy Petroleum Corporation  
Legal: N/2 S/2 SW/4 Sec 20-T26S-R20W  
Recordation: Bk 132 at Pg 137 in the Edwards Co., KS Register of Deeds Office

Instrument: Oil and Gas Lease  
Date: March 10, 2000  
Lessor: Virginia-Goldsberry and-Fred Goldsberry, wife and husband  
Lessee: McCoy Petroleum Corporation  
Legal: N/2 SW/4 Sec 20-T26S-R20W  
Recordation: Bk 132 at Pg 139 in the Edwards Co., KS Register of Deeds Office

Instrument: Oil and Gas Lease  
Date: March 10, 2000  
Lessor: Paul Wetzel and Pam Wetzel, husband and wife  
Lessee: McCoy Petroleum Corporation  
Legal: N/2 SW/4 Sec 20-T26S-R20W  
Recordation: Bk 132 at Pg 140 in the Edwards Co., KS Register of Deeds Office

Instrument: Oil and Gas Lease  
Date: March 11, 2000  
Lessor: Elizabeth Mobley, f/k/a Elizabeth Maskus, and Tom Mobley, wife and husband  
Lessee: McCoy Petroleum Corporation  
Legal: N/2 SW/4 Sec 20-T26S-R20W  
Recordation: Bk 132 at Pg 138 in the Edwards Co., KS Register of Deeds Office

Instrument: Oil and Gas Lease  
Date: March 10, 2000  
Lessor: Ruby L. Schwertfeger and Hilmer Schwertfeger, her husband  
Lessee: McCoy Petroleum Corporation  
Legal: S/2 S/2 SW/4 Sec 20 and the North 15 acres of the NW/4 Sec 29, O/D/A Lot 11 of the NW/4 Sec 29, all in T26S-R20W  
Recordation: Bk 132 at Pg 189 in the Edwards Co., KS Register of Deeds Office

Instrument: Oil and Gas Lease  
Date: March 10, 2000  
Lessor: Jerry W. Lightcap and Connie M. Lightcap, his wife  
Lessee: McCoy Petroleum Corporation  
Legal: S/2 S/2 SW/4 Sec 20 and the North 15 acres of the NW/4 Sec 29, O/D/A Lot 11 of the NW/4 Sec 29, all in T26S-R20W  
Recordation: Bk 132 at Pg 190 in the Edwards Co., KS Register of Deeds Office

---

**Oil and Gas Lease: Marcy A**

Dated: march 10, 2000  
Lessor: Janette Israel Marcy, f/k/a/ Janette Israel, and Douglas Marcy, wife and husband  
Lessee: McCoy Petroleum Corporation  
Description: Township 26 South, Range 20 West  
Section 19: SE/4  
Recorded: Edwards County, KANSAS in book 132 at page 128

---

**Oil and Gas Lease: Speirs A**

Dated: August 17, 1999  
Lessor: Ruth S. Speirs, Trustee  
Lessee: McCoy Petroleum Corporation  
Description: Township 26 South, Range 20 West  
Section 30: Lots 1, 2 & S/2 NE/4  
Recorded: Edwards County, KANSAS in book 131 at page 302



# ***Conveyance Document***

Please note the following draft deed/assignment has been prepared by the seller in advance of sale. The successful buyer agrees to accept title to the lots pursuant to said deeds or assignments. Seller shall not be obligated or required to modify or change said deeds or assignments unless a correction is required to properly convey the interests being sold.